Door Pulls & Plates Guide





The Door Hardware Professionals

Canaropa is a leading contract manufacturer, importer and distributor of quality commercial, residential and architectural door hardware. The reliable choice of professionals, developers and architects – our products are found throughout North America in private homes, residential developments, offices, commercial and industrial buildings and resorts.

Since 1954, Canaropa has been offering an extensive selection of reliable, quality door hardware, including door closers, locks, hinges, exit devices, security hardware and more. Coupled with regional offices, warehouses, and large inventory, we provide fast and reliable service to our customers from coast to coast.

Canaropa is focused on delivering the best possible service to its customers. With our dedicated team of experienced door hardware professionals, management and sales teams – we work hard to meet the needs of our customers by developing new products, delivering consulting services and staying current with trends in the market.

Professional & Technical Services

Whether it's a small residential project or a large multi-building development — Canaropa's hardware professionals can support you from the design stage all the way through to final construction.

Canaropa offers a variety of complimentary professional consulting and technical services to architects, designers and developers for commercial, residential, industrial, institutional, or hybrid projects:

PROFESSIONAL SERVICES

- Door hardware specification writing, review and conversion.
- Architectural hardware consultation.
- Budget preparation.
- Review substitution requests.

TECHNICAL SERVICES

- Technical project support and troubleshooting.
- Development and planning of common and high-security keying systems.
- In-house keying services – including high-security cylinders.
- Engraving services.

Our experienced hardware professionals are happy to help. They are well versed on local and national building codes, the unique needs of various types of facilities and egress requirements.

Take advantage of our experience and product knowledge today.

www.canaropa.com



DOOR PULLS

Ladder Pulls	5
Straight Mitered Pulls.....	9
Offset Pulls	12
Door or Millwork/Cabinet	14

DOOR PULL & PLATES

Door Pull with Back Plates.....	17
Door Pull & Back Plates	18
Kick Plates	19

FLUSH PULLS

Flush Pulls	21
Edge Pulls	25

MISCELLANEOUS PULLS

Bi-Fold Door Knobs	27
--------------------------	----

ABBREVIATIONS

DIA, ∅	Diameter
KG	Kilograms
LBS	Pounds
BS	Backset
LH	Left hand
LHR	Left hand reversed
MAX	Maximum
MIN	Minimum
N/A, —	Not applicable / Not available
QTY	Quantity (usually followed by notes)
RH	Right hand
RHR	Right hand reversed
SQ, ▣	Square
WT	Weight
/UNIT	Number of items per basic unit of sale (bagged or boxed)
/BOX, /BAG	Number of UNITS found in an inner carton or bag
/CASE	Number of BOXES or UNITS found in an outer (shipping) carton

The image displays three distinct architectural door pull designs against a dark, neutral background. The top pull is a T-shaped bar with a wide horizontal top section and a narrower vertical stem. The middle pull is a long, smooth cylindrical bar. The bottom pull is a rectangular bar with a wide horizontal top section and a narrower vertical stem, similar in shape to the top pull but with a different profile. All three pulls have a brushed metal finish and are arranged diagonally from the top-left towards the bottom-right.

ARCHITECTURAL
DOOR PULLS

DOREX 19R-E SERIES LADDER PULLS, ROUND, 1 1/4" DIAMETER



APPLICATIONS

- For wood or metal doors 1 3/8–2 1/4" (35–57 mm) thick
- For glass doors 5/16–1/2" (8–13 mm) thick

FEATURES

- 304 Stainless steel
- Available in paired or single pulls
- Single pulls are thru-bolt mounted with round end-caps
- All necessary mounting hardware included
- Matching washers for different finishes included
- Packaged in an eco-friendly, fully recyclable, box



SELECTION GUIDE

SERIES	LENGTH†	DIAMETER	TYPE	FINISH	DESCRIPTION
19R	24	E	B	630	Ladder Pull, 1 1/4" (32 mm) Round, 24" Center-to-Center, Back-to-Back, Satin Stainless Steel
	12, 24, 36 48, 60, 72	E 1-1/4 (32)	B Back-to-Back S Single	630 Satin Stainless Steel 19 Matte black	

IN (MM), †) CENTER-TO-CENTER.

NOT ALL COMBINATIONS OF STANDARD LENGTHS, TYPES & FINISHES ARE STOCKED. PLEASE REFER TO PRICE LIST OR CONTACT CANAROPA SALES AND SERVICE FOR DETAILS.



Single pulls are thru-bolt mounted with round end-caps

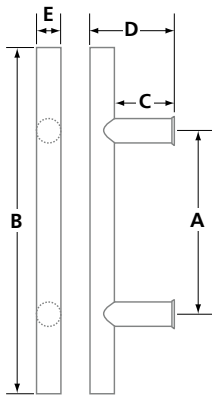
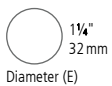

DIMENSIONS

MODEL	A CENTER-TO-CENTER	B TOTAL LENGTH	C POSTS	D PROJECTION	E DIAMETER
19R12	12 (305)	24 (610)	2 7/16 (62)	3 11/16 (94)	1 1/4 (32)
19R24	24 (610)	36 (915)	2 7/16 (62)	3 11/16 (94)	1 1/4 (32)
19R36	36 (915)	48 (1220)	2 7/16 (62)	3 11/16 (94)	1 1/4 (32)
19R48	48 (1220)	60 (1524)	2 7/16 (62)	3 11/16 (94)	1 1/4 (32)
19R60	60 (1524)	72 (1829)	2 7/16 (62)	3 11/16 (94)	1 1/4 (32)
19R72	72 (1829)	84 (2134)	2 7/16 (62)	3 11/16 (94)	1 1/4 (32)

IN (MM)

ARCHITECTURAL DOOR PULLS

DOREX 19R-E45 SERIES

LADDER PULLS, ROUND, 1 1/4" DIAMETER, OFFSET POSTS



APPLICATIONS

- For wood or metal doors 1 3/8–2 1/4" (35–57 mm) thick
- For glass doors 5/16–1/2" (8–13 mm) thick

FEATURES

- 304 Stainless steel
- Available in paired or single pulls
- Pull is offset for better functionality and aesthetics
- Simplified Stock Management: Convert back-to-back pairs to singles, and vice-versa (kit sold separately)
- Single pulls are thru-bolt mounted with round end-caps
- All necessary mounting hardware included
- Matching washers for different finishes included
- Offset clearance 2 25/32" (70.6 mm)

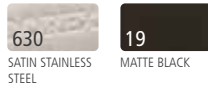

SELECTION GUIDE

SERIES	LENGTH†	DIAMETER	TYPE	OPTION	FINISH	DESCRIPTION
19R	24	E	B	45	630	Ladder Pull, 1 1/4" (32 mm) Round, 24" Center-to-Center, Back-to-Back, 45°, Satin Stainless Steel
	12, 24, 36 48, 60, 72	E 1-1/4 (32)	B Back-to-Back S Single	45 45 Degree	630 Satin Stainless Steel 19 Matte black	

IN (MM), †) CENTER-TO-CENTER.

NOT ALL COMBINATIONS OF STANDARD LENGTHS, TYPES & FINISHES ARE STOCKED. PLEASE REFER TO PRICE LIST OR CONTACT CANAROPA SALES AND SERVICE FOR DETAILS.



Single pulls are thru-bolt mounted with round end-caps

ACCESSORIES

19R45-B2B2SING-KIT-630	Kit to Reconfigure 1x 19R45-B2B PAIR to 2x 19R45-SINGLE-630
19R45-B2B2SING-KIT-19	Kit to Reconfigure 1x 19R45-B2B PAIR to 2x 19R45-SINGLE-19
19R45-2SING2B2B-KIT-630	Kit to Reconfigure 2x 19R45-SINGLE to 1x 19R45-B2B PAIR-630
19R45-2SING2B2B-KIT-19	Kit to Reconfigure 2x 19R45-SINGLE to 1x 19R45-B2B PAIR-19

DIMENSIONS

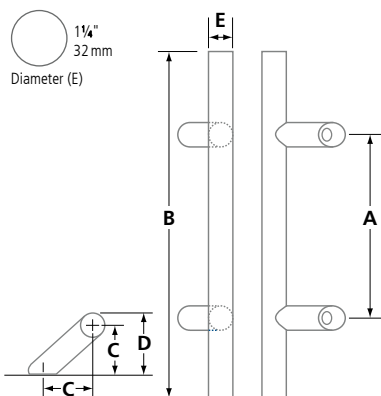

MODEL	A CENTER-TO-CENTER	B TOTAL LENGTH	C POSTS	D PROJECTION	E DIAMETER
19R12	12 (305)	24 (610)	2 25/32 (70.6)	3 13/32 (86.6)	1 1/4 (32)
19R24	24 (610)	36 (915)	2 25/32 (70.6)	3 13/32 (86.6)	1 1/4 (32)
19R36	36 (915)	48 (1220)	2 25/32 (70.6)	3 13/32 (86.6)	1 1/4 (32)
19R48	48 (1220)	60 (1524)	2 25/32 (70.6)	3 13/32 (86.6)	1 1/4 (32)
19R60	60 (1524)	72 (1829)	2 25/32 (70.6)	3 13/32 (86.6)	1 1/4 (32)
19R72	72 (1829)	84 (2134)	2 25/32 (70.6)	3 13/32 (86.6)	1 1/4 (32)

IN (MM)

DOREX 19R-E 316 SERIES

LADDER PULLS, ROUND, 1 1/4" DIAMETER, 316 MARINE GRADE



APPLICATIONS

- For wood or metal doors 1 3/8–2 1/4" (35–57 mm) thick
- For glass doors 5/16– 1/2" (8–13 mm) thick
- Ideal for outdoor use

FEATURES

- Marine grade, 316 stainless steel
- Available in paired or single pulls
- Single pulls are thru-bolt mounted with round end-caps
- All necessary mounting hardware included
- Washers included
- Packaged in an eco-friendly, fully recyclable, box



SELECTION GUIDE

SERIES	LENGTH†	DIAMETER	TYPE	FINISH	DESCRIPTION
19R	24	E	B	316	Ladder Pull, 1 1/4" (32 mm) Round, 24" Center-to-Center, Back-to-Back, 316 Satin Stainless Steel
	12, 24, 36 48, 60	E 1-1/4 (32)	B Back-to-Back S Single	316 Satin Stainless Steel	

IN (MM), †) CENTER-TO-CENTER.

NOT ALL COMBINATIONS OF STANDARD LENGTHS, TYPES & FINISHES ARE STOCKED. PLEASE REFER TO PRICE LIST OR CONTACT CANAROPA SALES AND SERVICE FOR DETAILS.



Single pulls are thru-bolt mounted with round end-caps

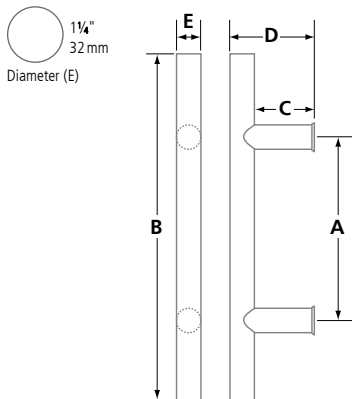

DIMENSIONS

MODEL	A CENTER-TO-CENTER	B TOTAL LENGTH	C POSTS	D PROJECTION	E DIAMETER
19R12	12 (305)	24 (610)	2 7/16 (62)	3 11/16 (94)	1 1/4 (32)
19R24	24 (610)	36 (915)	2 7/16 (62)	3 11/16 (94)	1 1/4 (32)
19R36	36 (915)	48 (1220)	2 7/16 (62)	3 11/16 (94)	1 1/4 (32)
19R48	48 (1220)	60 (1524)	2 7/16 (62)	3 11/16 (94)	1 1/4 (32)
19R60	60 (1524)	72 (1829)	2 7/16 (62)	3 11/16 (94)	1 1/4 (32)

IN (MM)

ARCHITECTURAL DOOR PULLS

DOREX 19Q-E SERIES LADDER PULLS, SQUARE, 1 1/4"



Single pulls are thru-bolt mounted with round end-caps

APPLICATIONS

- For wood or metal doors 1 3/8–2 1/4" (35–57 mm) thick
- For glass doors 5/16– 1/2" (8–13 mm) thick

FEATURES

- 304 Stainless steel
- Available in paired or single pulls
- Single pulls are thru-bolt mounted with round end-caps
- All necessary mounting hardware included
- Matching washers for different finishes included
- Packaged in an eco-friendly, fully recyclable, box



SELECTION GUIDE

SERIES	LENGTH†	DIAMETER	TYPE	FINISH	DESCRIPTION
19Q	24	E	B	630	Ladder Pull, 1 1/4" (32 mm) Square, 24" Center-to-Center, Back-to-Back, Satin Stainless Steel
	12, 24, 36	E 1-1/4 (32)	B Back-to-Back	630 Satin Stainless Steel	
	48, 60, 72		S Single	19 Matte black	

IN (MM), (†) CENTER-TO-CENTER.

NOT ALL COMBINATIONS OF STANDARD LENGTHS, TYPES & FINISHES ARE STOCKED. PLEASE REFER TO PRICE LIST OR CONTACT CANAROPA SALES AND SERVICE FOR DETAILS.

DIMENSIONS

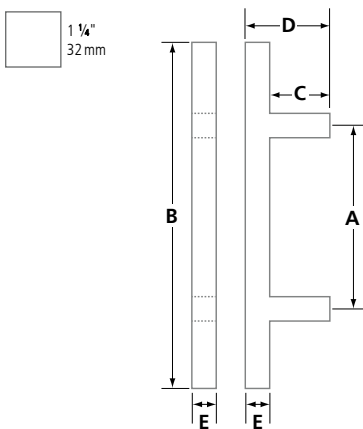

MODEL	A CENTER-TO-CENTER	B TOTAL LENGTH	C POSTS	D PROJECTION	E GRIP
19Q12	12 (305)	24 (610)	2 7/16 (62)	3 1/16 (94)	1 1/4 (32)
19Q24	24 (610)	36 (915)	2 7/16 (62)	3 1/16 (94)	1 1/4 (32)
19Q36	36 (915)	48 (1220)	2 7/16 (62)	3 1/16 (94)	1 1/4 (32)
19Q48	48 (1220)	60 (1524)	2 7/16 (62)	3 1/16 (94)	1 1/4 (32)
19Q60	60 (1524)	72 (1829)	2 7/16 (62)	3 1/16 (94)	1 1/4 (32)
19Q72	72 (1829)	84 (2134)	2 7/16 (62)	3 1/16 (94)	1 1/4 (32)

IN (MM)

DOREX 18R-E SERIES STRAIGHT ROUND PULLS, MITERED, 1 1/4" DIAMETER



APPLICATIONS

- For wood or metal doors 1 3/8 – 2 1/4" (35–57 mm) thick
- For glass doors 5/16 – 1/2" (8–13 mm) thick

FEATURES

- 304 Stainless steel
- Available in paired or single pulls
- Single pulls are thru-bolt mounted with round end-caps
- All necessary mounting hardware included
- Matching washers for different finishes included
- Packaged in an eco-friendly, fully recyclable, box



SELECTION GUIDE

SERIES	LENGTH†	DIAMETER	TYPE	FINISH	DESCRIPTION
18R	24	E	B	630	Straight Round Pull, 1 1/4" (32mm) Mitered, 24" Center-to-Center, Back-to-Back, Satin Stainless Steel
	24, 36	E 1-1/4 (32)	B Back-to-Back	630 Satin Stainless Steel	
	48, 60, 72		S Single	19 Matte black	

IN (MM), †) CENTER-TO-CENTER.

NOT ALL COMBINATIONS OF STANDARD LENGTHS, TYPES & FINISHES ARE STOCKED. PLEASE REFER TO PRICE LIST OR CONTACT CANAROPA SALES AND SERVICE FOR DETAILS.



Single pulls are thru-bolt mounted with round end-caps

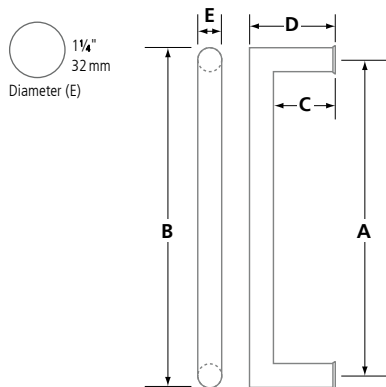

DIMENSIONS

MODEL	A CENTER-TO-CENTER	B TOTAL LENGTH	C POSTS	D PROJECTION	E DIAMETER
18R24	24 (610)	25 1/4 (641)	27/16 (62)	3 11/16 (94)	1 1/4 (32)
18R36	36 (915)	37 1/4 (946)	27/16 (62)	3 11/16 (94)	1 1/4 (32)
18R48	48 (1220)	49 1/4 (1251)	27/16 (62)	3 11/16 (94)	1 1/4 (32)
18R60	60 (1524)	61 1/4 (1556)	27/16 (62)	3 11/16 (94)	1 1/4 (32)
18R72	72 (1829)	73 1/4 (1861)	27/16 (62)	3 11/16 (94)	1 1/4 (32)

IN (MM)

ARCHITECTURAL DOOR PULLS

DOREX 18Q-E SERIES

STRAIGHT SQUARE PULLS, MITERED, 1 1/4"



Single pulls are thru-bolt mounted with round end-caps

APPLICATIONS

- For wood or metal doors 1 3/8"– 2 1/4" (35–57 mm) thick
- For glass doors 5/16"– 1/2" (8–13 mm) thick

FEATURES

- 304 Stainless steel
- Available in paired or single pulls
- Single pulls are thru-bolt mounted with round end-caps
- All necessary mounting hardware included
- Matching washers for different finishes included
- Packaged in an eco-friendly, fully recyclable, box



SELECTION GUIDE

SERIES	LENGTH†	DIAMETER	TYPE	FINISH	DESCRIPTION
18Q	24	E	B	630	Straight Square Pull, 1 1/4" (32 mm) Mitered, 24" Center-to-Center, Back-to-Back, Satin Stainless Steel
	24, 36	E 1-1/4 (32)	B Back-to-Back	630 Satin Stainless Steel	
	48, 60, 72		S Single	19 Matte black	

IN (MM), †) CENTER-TO-CENTER.

NOT ALL COMBINATIONS OF STANDARD LENGTHS, TYPES & FINISHES ARE STOCKED. PLEASE REFER TO PRICE LIST OR CONTACT CANAROPA SALES AND SERVICE FOR DETAILS.

DIMENSIONS

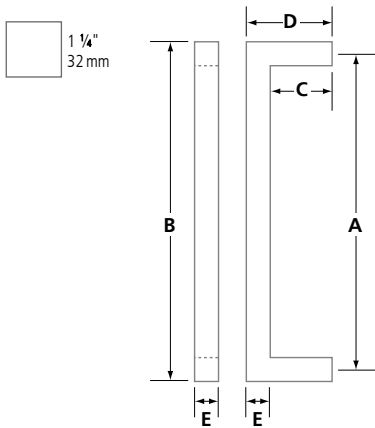

MODEL	A CENTER-TO-CENTER	B TOTAL LENGTH	C POSTS	D PROJECTION	E GRIP
18Q24	24 (610)	25 1/4 (641)	27/16 (62)	3 11/16 (94)	1 1/4 (32)
18Q36	36 (915)	37 1/4 (946)	27/16 (62)	3 11/16 (94)	1 1/4 (32)
18Q48	48 (1220)	49 1/4 (1251)	27/16 (62)	3 11/16 (94)	1 1/4 (32)
18Q60	60 (1524)	61 1/4 (1556)	27/16 (62)	3 11/16 (94)	1 1/4 (32)
18Q72	72 (1829)	73 1/4 (1861)	27/16 (62)	3 11/16 (94)	1 1/4 (32)

IN (MM)

DOREX 18T-F SERIES

STRAIGHT RECTANGULAR PULLS, MITERED, 1½" x 1"



APPLICATIONS

- For wood or metal doors 1¾– 2¼" (35–57mm) thick
- For glass doors ⅝– ½" (8–13 mm) thick

FEATURES

- 304 Stainless steel
- Available in paired or single pulls
- Single pulls are thru-bolt mounted with round end-caps
- All necessary mounting hardware included
- Matching washers for different finishes included
- Packaged in an eco-friendly, fully recyclable, box



SELECTION GUIDE

SERIES	LENGTH†	DIMENSION	TYPE	FINISH	DESCRIPTION
18T	24	F	B	630	Straight Rectangular Pull, 1½x1" (38x25.4mm) Mitered, 24" Center-to-Center, Back-to-Back, Satin Stainless Steel
	24, 36 48, 60, 72	F 1-1/2x1 (38x25.4)	B Back-to-Back S Single	630 Satin Stainless Steel 19 Matte black	

IN (MM), †) CENTER-TO-CENTER.

NOT ALL COMBINATIONS OF STANDARD LENGTHS, TYPES & FINISHES ARE STOCKED. PLEASE REFER TO PRICE LIST OR CONTACT CANAROPA SALES AND SERVICE FOR DETAILS.



Single pulls are thru-bolt mounted with round end-caps

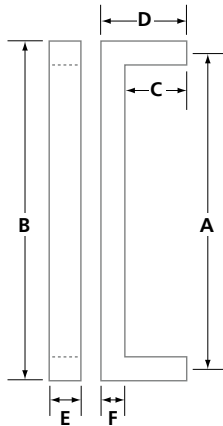
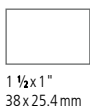

DIMENSIONS

MODEL	A CENTER-TO-CENTER	B TOTAL LENGTH	C POSTS	D PROJECTION	E GRIP WIDTH	F GRIP HEIGHT
18T24	24 (610)	25 (635)	2⅝ (67)	3⅝ (92.4)	1½ (38)	1 (25.4)
18T36	36 (915)	37 (940)	2⅝ (67)	3⅝ (92.4)	1½ (38)	1 (25.4)
18T48	48 (1220)	49 (1245)	2⅝ (67)	3⅝ (92.4)	1½ (38)	1 (25.4)
18T60	60 (1524)	61 (1549)	2⅝ (67)	3⅝ (92.4)	1½ (38)	1 (25.4)
18T72	72 (1829)	73 (1854)	2⅝ (67)	3⅝ (92.4)	1½ (38)	1 (25.4)

IN (MM)

ARCHITECTURAL DOOR PULLS

DOREX 20R-E SERIES

OFFSET ROUND D-PULLS, MITERED, 1 1/4" DIAMETER



APPLICATIONS

- For wood or metal doors 1 3/8–2 1/4" (35–57 mm) thick
- For glass doors 5/16–1/2" (8–13 mm) thick

FEATURES

- 304 Stainless steel
- Available in paired or single pulls
- Single pulls are thru-bolt mounted with round end-caps
- All necessary mounting hardware included
- Matching washers for different finishes included
- Packaged in an eco-friendly, fully recyclable, box



630
SATIN STAINLESS
STEEL



19
MATTE BLACK

SELECTION GUIDE

SERIES	LENGTH*	DIAMETER	TYPE	FINISH	DESCRIPTION
20R	24	E	B	630	Offset Round D-Pull, 1 1/4 (32 mm) Mitered, 24" Center-to-Center, Back-to-Back, Satin Stainless Steel Finish
	10, 24, 36 48, 60	E 1-1/4 (32)	B Back-to-Back S Single	630 Satin Stainless Steel 19 Matte black	

IN (MM), (†) CENTER-TO-CENTER.

NOT ALL COMBINATIONS OF STANDARD LENGTHS, TYPES & FINISHES ARE STOCKED. PLEASE REFER TO PRICE LIST OR CONTACT CANAROPA SALES AND SERVICE FOR DETAILS.



Single pulls are thru-bolt mounted with round end-caps

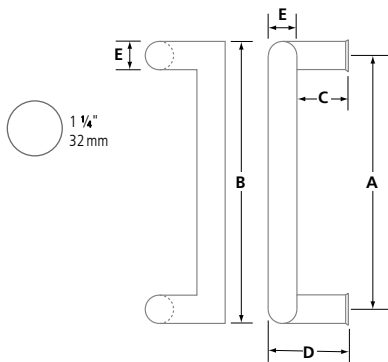

DIMENSIONS

MODEL	A CENTER-TO-CENTER	B TOTAL LENGTH	C POSTS	D PROJECTION	E DIAMETER
20R10	10 (254)	11 1/4 (286)	27/16 (62)	3 11/16 (94)	1 1/4 (32)
20R24	24 (609.6)	25 1/4 (641)	27/16 (62)	3 11/16 (94)	1 1/4 (32)
20R36	36 (914.4)	37 1/4 (946)	27/16 (62)	3 11/16 (94)	1 1/4 (32)
20R48	48 (1219.2)	49 1/4 (1251)	27/16 (62)	3 11/16 (94)	1 1/4 (32)
20R60	60 (1524)	61 1/4 (1556)	27/16 (62)	3 11/16 (94)	1 1/4 (32)

IN (MM)

DOREX 20T-E SERIES

OFFSET RECTANGULAR D-PULLS, MITERED, 1 1/4" x 3/4" DIAMETER



APPLICATIONS

- For wood or metal doors 1 3/8–2 1/4" (35–57 mm) thick
- For glass doors 5/16–1/2" (8–13 mm) thick

FEATURES

- 304 Stainless steel
- Available in paired or single pulls
- Single pulls are thru-bolt mounted with round end-caps
- All necessary mounting hardware included
- Matching washers for different finishes included
- Can be installed on 2" (51 mm) aluminum doors and frame with 1/2" (12.7 mm) door stop
- Packaged in an eco-friendly, fully recyclable, box



SELECTION GUIDE

SERIES	LENGTH†	DIMENSION	TYPE	FINISH	DESCRIPTION
20T	24	E	B	630	Offset Rectangular D-Pull, 1 1/4 x 3/4" (32 x 19 mm) Mitered, 24" Center-to-Center, Back-to-Back, Satin Stainless Steel
	10, 24, 36 48, 60	E 1-1/4 x 3/4 (32 x 19)	B Back-to-Back S Single	630 Satin Stainless Steel 19 Matte black	

IN (MM), †) CENTER-TO-CENTER.

NOT ALL COMBINATIONS OF STANDARD LENGTHS, TYPES & FINISHES ARE STOCKED. PLEASE REFER TO PRICE LIST OR CONTACT CANAROPA SALES AND SERVICE FOR DETAILS.



Single pulls are thru-bolt mounted with round end-caps

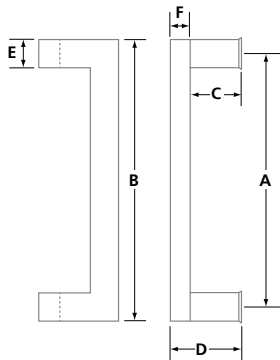

DIMENSIONS

MODEL	A CENTER-TO-CENTER	B TOTAL LENGTH	C POSTS	D PROJECTION	E GRIP WIDTH	F GRIP HEIGHT
20T10	10 (254)	11 1/4 (286)	2 1/16 (68)	3 7/16 (87)	1 1/4 (32)	3/4 (19)
20T24	24 (609.6)	25 1/4 (641)	2 1/16 (68)	3 7/16 (87)	1 1/4 (32)	3/4 (19)
20T36	36 (914.4)	37 1/4 (946)	2 1/16 (68)	3 7/16 (87)	1 1/4 (32)	3/4 (19)
20T48	48 (1219.2)	49 1/4 (1251)	2 1/16 (68)	3 7/16 (87)	1 1/4 (32)	3/4 (19)
20T60	60 (1524)	61 1/4 (1556)	2 1/16 (68)	3 7/16 (87)	1 1/4 (32)	3/4 (19)

IN (MM)

ARCHITECTURAL DOOR PULLS

DOREX 18R-B SERIES

STRAIGHT ROUND PULLS, MITERED, 3/4" DIAMETER



APPLICATIONS

- For wood or metal doors & panels 1 3/8– 2 1/4" (35–57 mm) thick
- For glass doors 5/16– 1/2" (8–13 mm) thick
- Ideal for millwork/cabinet applications

FEATURES

- Stainless steel
- Available in paired or single pulls
- Single pulls are thru-bolt mounted with round end-caps
- All necessary mounting hardware included
- Washers included (clear plastic)



SELECTION GUIDE

SERIES	LENGTH†	DIAMETER	TYPE	FINISH	DESCRIPTION
18R	24	B	B	630	Straight Round Pull, 3/4" (19mm) Mitered, 24" Center-to-Center, Back-to-Back, Satin Stainless Steel
	12, 16, 24	B 3/4 (19)	B Back-to-Back S Single	630 Satin Stainless Steel 19 Matte black	

IN (MM), †) CENTER-TO-CENTER.

NOT ALL COMBINATIONS OF STANDARD LENGTHS, TYPES & FINISHES ARE STOCKED. PLEASE REFER TO PRICE LIST OR CONTACT CANAROPA SALES AND SERVICE FOR DETAILS.



Single pulls are thru-bolt mounted with round end-caps



18R-BWBB-KIT-630 BOWL WASHERS

- Replaces included washers for an optional aesthetic look
- 2 Washers per kit

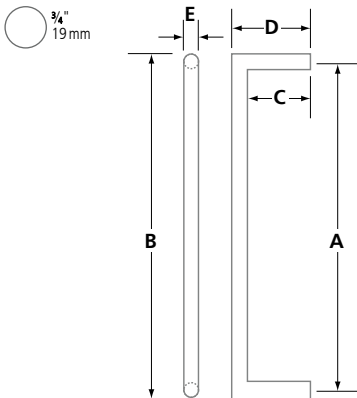

DIMENSIONS

MODEL	A CENTER-TO-CENTER	B TOTAL LENGTH	C POSTS	D PROJECTION	E DIAMETER
18R12	11 13/16 (300)	12 9/16 (319)	1 3/4 (44)	2 1/2 (63.5)	3/4 (19)
18R16	15 3/4 (400)	16 1/2 (419)	1 3/4 (44)	2 1/2 (63.5)	3/4 (19)
18R24	23 5/8 (600)	24 3/8 (619)	1 3/4 (44)	2 1/2 (63.5)	3/4 (19)

IN (MM)

DOREX 19R-B SERIES LADDER ROUND PULLS, 3/4" DIAMETER



APPLICATIONS

- For wood or metal doors & panels 1 3/8– 2 1/4" (35–57 mm) thick
- For glass doors 5/16– 1/2" (8–13 mm) thick
- Ideal for millwork/cabinet applications

FEATURES

- Stainless steel
- Available in paired or single pulls
- Single pulls are thru-bolt mounted with round end-caps
- All necessary mounting hardware included
- Washers included (clear plastic)

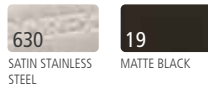

SELECTION GUIDE

SERIES	LENGTH†	DIAMETER	TYPE	FINISH	DESCRIPTION
19R	24	B	B	630	Ladder Pull, 3/4" (19mm) Round, 24" Center-to-Center, Back-to-Back, Satin Stainless Steel
	12, 16, 24	B 3/4 (19)	B Back-to-Back S Single	630 Satin Stainless Steel 19 Matte black	

IN (MM), †) CENTER-TO-CENTER.

NOT ALL COMBINATIONS OF STANDARD LENGTHS, TYPES & FINISHES ARE STOCKED. PLEASE REFER TO PRICE LIST OR CONTACT CANAROPA SALES AND SERVICE FOR DETAILS.



Single pulls are thru-bolt mounted with round end-caps



18R-BWBB-KIT-630 BOWL WASHERS

- Replaces included washers for an optional aesthetic look
- 2 Washers per kit

DIMENSIONS

MODEL	A CENTER-TO-CENTER	B TOTAL LENGTH	C POSTS	D PROJECTION	E DIAMETER
19R12	11 13/16 (300)	17 3/4 (450)	1 3/4 (44)	2 1/2 (63.5)	3/4 (19)
19R16	15 3/4 (400)	21 5/8 (550)	1 3/4 (44)	2 1/2 (63.5)	3/4 (19)
19R24	21 5/8 (550)	27 9/16 (700)	1 3/4 (44)	2 1/2 (63.5)	3/4 (19)

IN (MM)

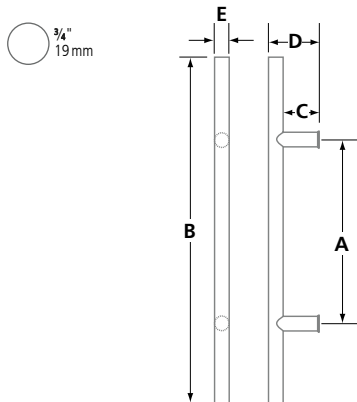

DOOR PULLS & PLATES



DOOR PULL WITH BACK PLATE



H1410

- D-Type door pull
- Supplied with six #6 x 3/4" (19.1 mm) long wood screws, two 1/4-20 UNC x 2 3/8" (60mm) long machine screws and cup-washers



AL
ALUMINUM

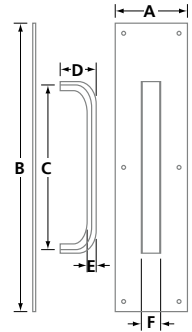

MODEL	MATERIAL	A	B	C	D	E	F
H1410	Aluminum	4 (102)	16 (406)	9 (229)	2 1/16 (52)	1/2 (12.7)	1 1/16 (26.9)
H1411	Aluminum	3 1/2 (89)	15 (381)	7 (178)	2 1/16 (52)	1/2 (12.7)	1 1/16 (26.9)

IN (MM)



14R09P-32D

- Round door pull
- Supplied with six #6 x 3/4" (19.1 mm) long wood screws, two 1/4-20 UNC x 2 3/8" (60mm) long machine screws and cup-washers



32D
STAINLESS STEEL

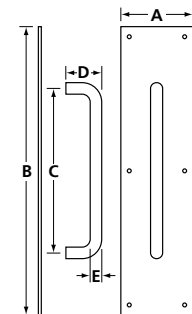

MODEL	FINISH	MATERIAL	A	B	C	D	∅ E
14R09P	32D	Stainless steel	4 (102)	16 (406)	9 (229)	2 1/4 (57)	3/4 (19.1)

IN (MM)

DOOR PULLS & PLATES

DOOR PULLS



- Supplied with two ¼-20 UNC x 2 ¾ (60mm) long flat-head machine screws and cup-washers



MODEL	FINISH	MATERIAL	A	B	C
H1412	-C28	Aluminum	2 (50.8)	1 1/16 (26.9)	7 (178)
H1413	-C28	Aluminum	2 (50.8)	1 1/16 (26.9)	9 (229)
14R09	-32D	Stainless steel	2 (50.8)	¾ (19.1)	9 (229)

IN (MM)

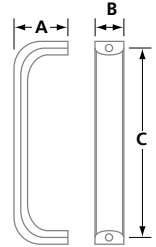

PULL BACK PLATES



- Back plate for commercial pulls
- Mounting hardware included: wood screws



MODEL	FINISH	MATERIAL	A	B	C
130315	-AL	Aluminum	3 1/2 (89)	15 (381)	7 (177.8)
130416	-32D	Stainless steel	4 (102)	16 (406)	9 (228.6)

IN (MM)

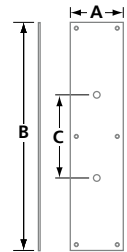

PUSH PLATES



- Mounting hardware included: wood screws



MODEL	FINISH	MATERIAL	A	B
140315	-AL	Aluminum	3 1/2 (89)	15 (381)
140416	-32D	Stainless steel	4 (102)	16 (406)
140520	-AL	Aluminum	5 (127)	20 (508)

IN (MM)

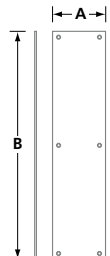

KICK PLATES



151234-32D

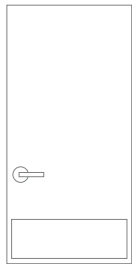
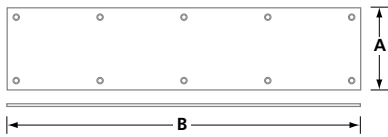

H = 8 to 12"
(203–305 mm)
W = [total width of the door]
– 1½" (38 mm)

- Mounting hardware included: wood screws



MODEL	FINISH	MATERIAL	TYPE	A	B
150828				8 (203)	28½ (724)
150830				8 (203)	30½ (775)
150832	AL	Aluminum	Kick	8 (203)	32½ (826)
	32D	Stainless steel		8 (203)	34½ (876)
	-BP032	Brass		8 (203)	42½ (1080)
150834				8 (203)	34½ (876)
150842				8 (203)	42½ (1080)
151028				10 (254)	28½ (724)
151030	AL	Aluminum	Kick	10 (254)	30½ (775)
	32D	Stainless steel		10 (254)	32½ (826)
	-BP032	Brass		10 (254)	34½ (876)
151032				10 (254)	34½ (876)
151034				10 (254)	34½ (876)
151234	AL	Aluminum	Kick	12 (305)	34½ (876)
	32D	Stainless steel		12 (305)	
	-BP032	Brass		12 (305)	

IN (MM)

FLUSH PULLS



FLUSH PULLS



FP410-135-630

FP412-135-630

- For wood doors and panels
- Stainless steel with plastic components
- Available with or without spring cover

*Dimensions for reference only.
Please request samples prior to door preparation.*



629

POLISHED
STAINLESS STEEL

630

SATIN STAINLESS
STEEL

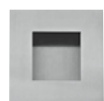
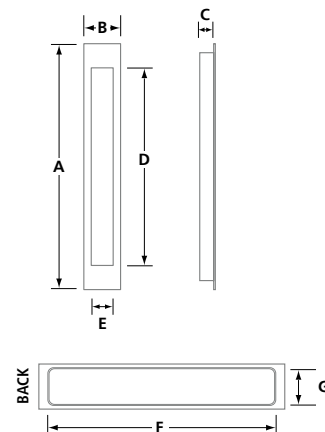

FP414-60-630



FP416-300-630

MODEL	FINISH	A	B	C	D	E	F	G
FP410-135	-629,	5 ⁵ / ₁₆	2 ³ / ₄	1 ¹ / ₁₆	3 ¹⁵ / ₁₆	1	4 ¹⁵ / ₁₆	1 ¹³ / ₁₆
	-630	(135)	(70)	(17)	(100)	(25)	(125)	(46)
FP412-135	-629,	5 ⁵ / ₁₆	2 ³ / ₁₆	1 ¹ / ₁₆	3 ¹⁵ / ₁₆	1	4 ¹⁵ / ₁₆	1 ¹³ / ₁₆
	-630	(135)	(55)	(17)	(100)	(25)	(125)	(46)
FP414-60	-629,	2 ³ / ₈	2 ³ / ₈	1 ¹ / ₁₆	1 ³ / ₁₆	1 ³ / ₁₆	2	2
	-630	(60)	(60)	(17)	(30)	(30)	(50)	(50)
FP416-300	-629,	11 ¹³ / ₁₆	2 ³ / ₁₆	1 ¹ / ₁₆	1	1	10 ⁷ / ₈	1 ¹³ / ₁₆
	-630	(300)	(55)	(17)	(25)	(25)	(276)	(46)
WITH SPRING COVER								
FPC402-135*	-629,	5 ⁵ / ₁₆	2 ³ / ₁₆	1 ¹ / ₁₆	3 ¹⁵ / ₁₆	1	4 ¹⁵ / ₁₆	1 ¹³ / ₁₆
	-630	(135)	(55)	(17)	(100)	(25)	(125)	(46)
FPC406-300*	-629,	11 ¹³ / ₁₆	2 ³ / ₁₆	1 ¹ / ₁₆	9 ¹³ / ₁₆	1	10 ¹⁵ / ₁₆	1 ¹³ / ₁₆
	-630	(300)	(55)	(17)	(250)	(25)	(278)	(46)

IN (MM) (*) SPECIAL ORDER



FPC402-135-630



FPC406-300-630

FLUSH PULLS

FLUSH PULLS

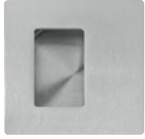

FP224-70-630



FP224-110-630



FP225-110-630

- For wood doors
- Stainless steel
- Round backplate for easy installation
- Back-to-back mounting possible

*Dimensions for reference only.
Please request samples prior to door preparation.*

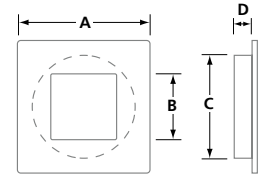

MODEL	FINISH	A	B	∅ C	D	E	F	G
FP224-70	-630	2 3/4 (70)	1 1/4 (40)	2 3/8 (60)	5/8 (15)	1 (25)	—	—
FP224-110	-630	4 5/16 (110)	2 11/16 (68)	4 (102)	5/8 (15)	1 5/16 (34)	—	—
FP225-110	-630	∅ 4 5/16 (110)	∅ 3 3/8 (86)	4 (102)	9/16 (14)	—	—	—

IN (MM)



FP231-180-630

- For wood doors
- Stainless steel
- Round backplate for easy installation
- Back-to-back mounting possible

*Dimensions for reference only.
Please request samples prior to door preparation.*

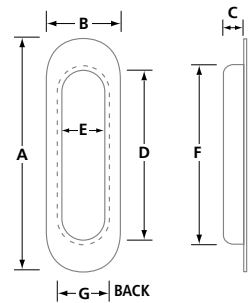

MODEL	FINISH	A	B	∅ C	D	E	F	G
FP231-180	-630	7 3/32 (180)	2 3/8 (60)	9/16 (14)	5 1/2 (140)	1 1/16 (26)	5 13/16 (148)	1 7/16 (37)

IN (MM)

FLUSH PULLS

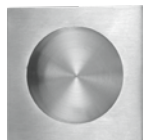

FP223R-64-630



FP223-50-630

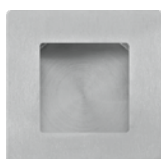

FP223-70-630



FP225-50-630



FP225-70-630

- For wood doors
- Stainless steel
- Round backplate for easy installation
- Back-to-back mounting possible

*Dimensions for reference only.
Please request samples prior to door preparation.*

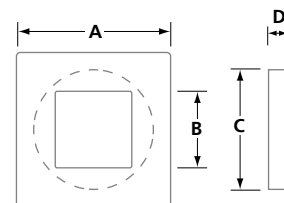
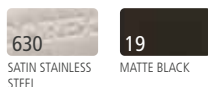

MODEL	FINISH	A	B	ø C	D
FP223R-64	-630, -19	2 1/2 (64)	ø 1 3/4 (45)	2 1/8 (54)	1/2 (12.7)
FP223-50	-630	2 (50)	ø 1 1/16 (26)	1 9/16 (40)	7/16 (11.5)
FP223-70	-630, -19	2 3/4 (70)	ø 1 9/16 (40)	2 3/8 (60)	1/2 (13.2)
FP225-50	-630	2 (50)	ø 1 1/4 (31)	1 9/16 (40)	7/16 (10.7)
FP225-70	-630, -19	2 3/4 (70)	ø 2 (50)	2 3/8 (60)	1/2 (13.2)

IN (MM)



FP227-120-630



FP228-120-630

- For wood doors
- Stainless steel
- Back-to-back mounting possible

*Dimensions for reference only.
Please request samples prior to door preparation.*

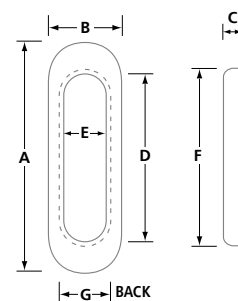
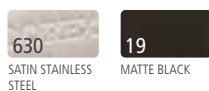

MODEL	FINISH	A	B	C	D	E	F	G
FP227-120	-630, -19	4 11/16 (120)	1 5/8 (40)	7/16 (11)	3 5/16 (85)	7/8 (22)	3 5/8 (92)	1 1/16 (27)
FP228-120	-630, -19	4 11/16 (120)	1 5/8 (40)	7/16 (11)	3 5/16 (85)	7/8 (22)	3 5/8 (92)	1 1/16 (27)
FP412-135B	-630, -19	5 5/16 (135)	2 3/16 (55)	7/16 (11.5)	3 15/16 (100)	1 (25)	4 1/2 (114.5)	1 1/4 (32)

IN (MM)



FP412-135B-630

FLUSH PULLS

FLUSH PULLS



2530C26-CHR

- For wood doors
- Steel
- Wood screws included

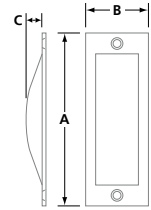

MODEL	FINISH	A	B	C	CUT-OUT DIMENSION	/BOX
2530	BP, C11P, C15, C15A, C19, CHR, C26D	4½ (114)	1⅝ (40)	½ (12.7)	1 ⅝/16 x 3 ½ x ½ (33.3 x 89 x 12.7)	50

IN (MM)



3503-26D

- For wood doors
- Steel
- Fasteners NOT included

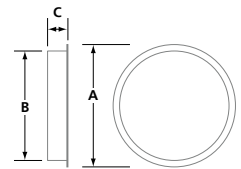

MODEL	FINISH	ø A	ø B	C	CUT-OUT DIMENSION	/BOX
3503	11P, 15, 15A, 19, 26, 26D	2 7/16 (62)	2 1/16 (52)	3/8 (9.5)	2 1/8 DIA x 1/2 (54 DIA x 12.7)	100

IN (MM)



4100SS

- For wood doors
- Stainless steel
- Fasteners NOT included

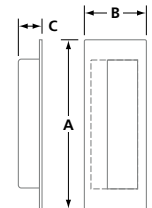

MODEL	FINISH	A	B	C	CUT-OUT DIMENSION	/BOX
4100SS	Stainless steel	4½ (114)	1⅝ (40)	½ (12.7)	1 ⅝/16 x 3 ¾ x ⅝ (33.3 x 95 x 15.9)	25

IN (MM)

EDGE PULLS



EP310-30-630

- For wood panels or doors
- Stainless steel
- Wood screws included

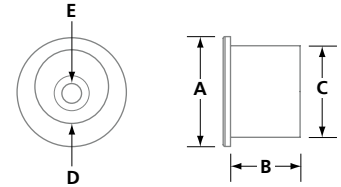

MODEL	FINISH	MATERIAL	ø A	B	ø C	ø D	ø E
EP310-30	-630	Stainless Steel	1 3/16 (30)	3/4 (19.5)	1 (25)	13/16 (20.5)	3/16 (4.5)

IN (MM)



EP312-154-630

- For wood panels or doors
- Stainless steel

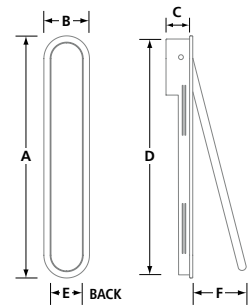

MODEL	FINISH	MATERIAL	A	B	C	D	E	F
EP312-154	-630	Stainless Steel	6 3/16 (158)	1 3/16 (30)	5/8 (16)	5 19/16 (151)	1 (25)	3 5/16 (84)

IN (MM)



3512-32D

- For wood panels or doors
- Wood screws included

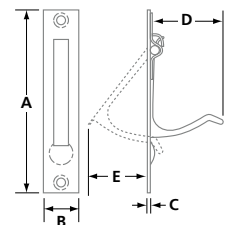

MODEL	FINISH	MATERIAL	A	B	C	D	E	/BOX
3512	-32D	Brass	3 7/8 (98)	3/4 (19.1)	5/64 (2)	1 9/16 (39.6)	1 1/4 (31.8)	25

IN (MM)

BI-FOLD DOOR KNOBS



KNOB PULLS



3520C26D

• For 1 3/8" (35 mm) thick doors

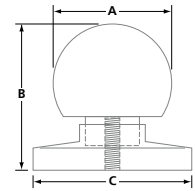

MODEL	FINISH	MATERIAL	ø A	B	ø C	/BOX
3520	C3, C5, C11P, C15, C15A, C19, C26, C26D	Zinc die-cast	1 1/4 (31.8)	1 5/8 (41.3)	1 3/4 (44.5)	50

IN (MM)



3521C26

• For 1 3/8" (35 mm) thick doors

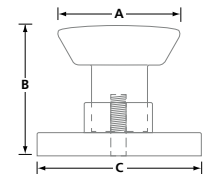

MODEL	FINISH	MATERIAL	ø A	B	ø C	D
3521	C15, C19, C26, C26D	Zinc die-cast	1 1/4 (31.8)	1 1/16 (17)	1 (25)	3/4 (20.5)

IN (MM)

The Door
Hardware
Professionals

