

WINDOW CATCHES & LATCHES

GENERAL HARDWARE

TRANSOM CATCH

DC25

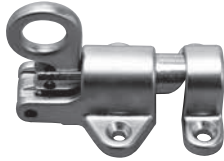

SUSAP49



SUSAP49FS



HR216

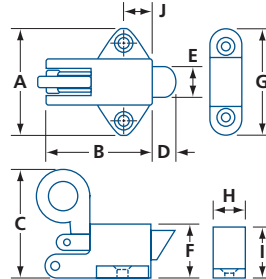

- Spring loaded latch
- Includes keeper
- Optional strikes sold separately
 - #SUSAP49 Flat strike
 - #SUSAP49FS Sash strike
 - #HR216 Replacement keeper

MODEL	FINISH	MATERIAL	A	B	C	D	E	F	G	H	I	J	/BOX
DC25	SL	Zinc die-cast	1 ¹³ / ₁₆ (46)	1 ³ / ₄ (44.5)	1 ³ / ₄ (44.5)	1 ⁹ / ₃₂ (10.3)	1/2 (12.7)	7/8 (22.2)	1 ³ / ₄ (44.5)	1/2 (12.7)	7/8 (22.2)	1/2 (12.7)	20

IN (MM)

TRANSOM CATCH

5215

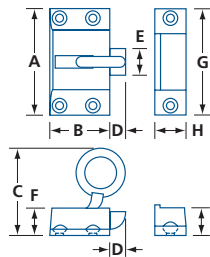
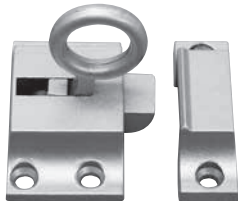

- Spring loaded latch
- Includes keeper
- Mounting hardware included: wood screws

MODEL	FINISH	MATERIAL	A	B	C	D	E	F	G	H	I	/BOX
5215	SL	Zinc die-cast	2 (50.8)	1 ¹ / ₈ (28.6)	1 ⁵ / ₈ (41.3)	5/16 (7.9)	1/2 (12.7)	1/2 (12.7)	2 (50.8)	1 ⁹ / ₃₂ (15.1)	1/2 (12.7)	20

IN (MM)

SASH HOOK

DC60



- Zinc die-cast hook
- Chrome plated
- Available with 3/4" (19 mm) diameter, 6 ft. or 12 ft. (1.83 m or 3.66 m) vinyl covered wood pole

MODEL	DESCRIPTION	/BOX
DC60	Hook only, no pole	30
DC60P	Hook with 6 ft. (1.83 m) vinyl covered pole	20
DC60P144	Hook with 12 ft. (3.66 m) vinyl covered pole	10