

ELECTRONIC

DEADBOLT LOCK

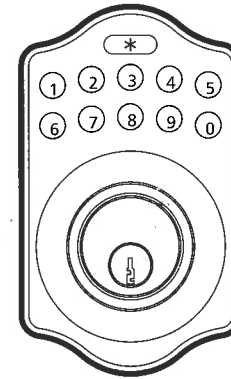

USER MANUAL



Attention : Please do not use an "electric" screwdriver for installation.

ELECTRONIC DEADBOLT LOCK INSTALLATION INSTRUCTIONS

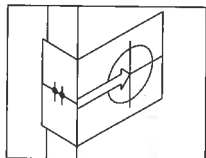

The BACKSET is the distance between the center of cross bore and edge bore of the door. Adjustable latch fits both BACKSET of 2-3/8" (60mm) and 2-3/4" (70mm). Please follow the steps shown below for BACKSET adjustment.

Latch Backset Adjustment :

Rotate the latch case as per the diagram on the right for backset 2-3/4" (70mm) or reverse direction for 2-3/8" (60mm).

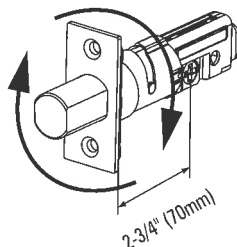

1. Mark The Door With Template

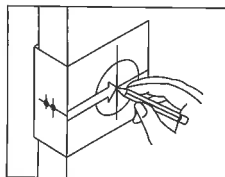

Select the height and backset as desired on the door face ; use the TEMPLATE to mark the center of the circle on the door face and the center on the door edge.

2. Drill Holes

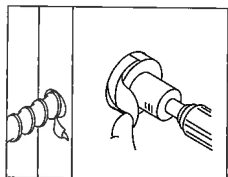

Using the marks as a guide, drill a hole \varnothing 2-1/8" (54mm) through the door face for the lockset, then a hole of \varnothing 1" (25.4mm) for the latch.

3. Install Latch

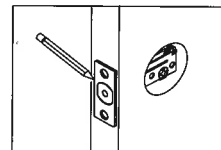

a. Insert the latch and ensure it is parallel to the door edge. Mark the outline of the faceplate, then remove the latch.

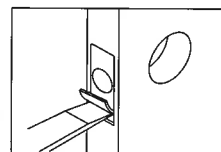

b. Chisel 1/8" (3mm) deep along the outline to allow the faceplate to be flush with the surface on the door edge.

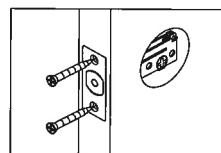

c. Insert the latch and fasten with screws. Note : "self tapping" screws are required on metal doors.

4. Install Strike

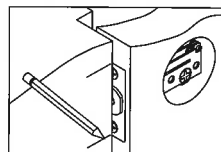

a. To identify the center of strike : close the door, with reference to the faceplate, mark horizontal center line of strike. Ensure the center of faceplate and the center of strike are aligned. Use the mark as a guide to outline the strike.

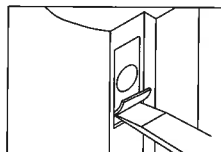

b. Chisel 5/64" (2mm) deep along the strike outline to allow the strike to be flush with the surface of the doorframe.

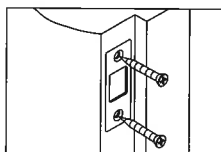

c. Insert the strike and fasten with screws. Note : "self tapping" screws are required on metal doors.

5. Install Electronic Deadbolt Lock

- Ensure the latch bolt is retracted.
- Place deadbolt against keypad with tailpiece in horizontal position and insert through hub of the latch.
- Pass the IC wire **under the latch** to the interior side of the door.

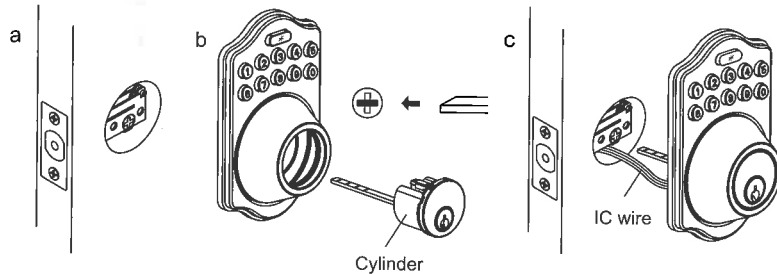

6. Install Inside Mounting Plate

Pass the IC wire **through the wire hole cut out** on the mounting plate.
Fix the mounting plate with screws.
If outside lock assembly is misaligned, please loosen the screws to adjust it's position and then re-tighten the screws.

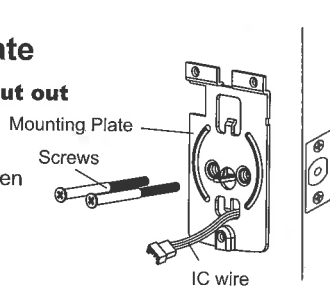

7. Identify Door Handing

Face the door from outside, the door is left handed if the hinge is on the left-hand side of the door, whereas the door is right handed if the hinge is on the right-hand side of the door.

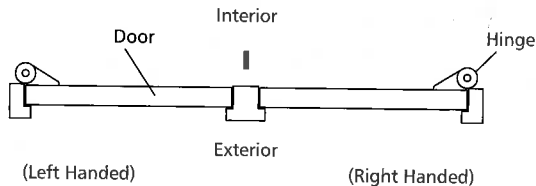

8. Adjusting Thumb Turn

Turn the thumb turn to the left 45 degrees when it's right-handed door.
Turn the thumb turn to the right 45 degrees when it's left handed door.

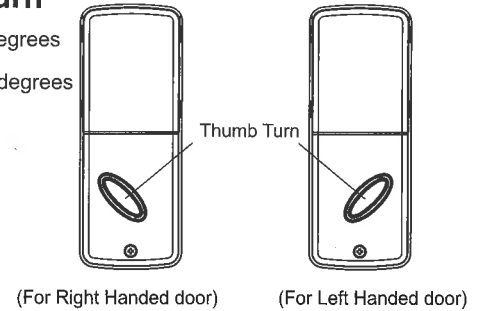

9. Install receiver module

- Remove the battery cover (slide upward and pull out)
- Connect the IC wire and ensure the tailpiece is engaged with thumb turn, then attach receiver module to the mounting plate with the machine screws and, if required, onto the door with wooden screws (optional).
- Insert 4 (AA) 1.5V alkaline batteries and place battery cover by sliding onto the receiver module.

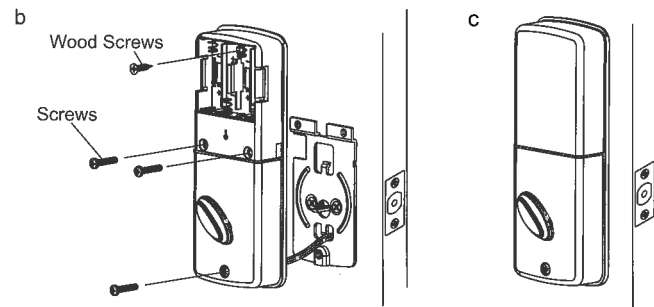
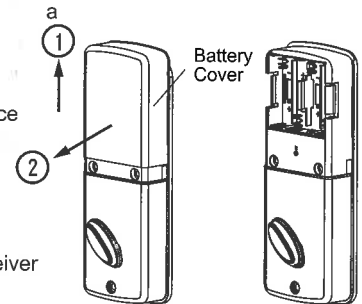

■ Specification/Function

1. Battery

Four AA (1.5V) Alkaline batteries.

2. Low Battery

- 2-1 The batteries should be changed immediately once the LED flashes in red or when constant beeping sounds are heard for 10 seconds when programming button is pressed.
- 2-2 All settings are stored in memory and will not be lost even if the battery is completely drained.
- 2-3 The lock can still be operated by key when a battery power is lost.

3. LED Indicator

- 3-1 LED flashes green once : Correct Operation
- 3-2 LED flashes green twice : Programmed Successfully
- 3-3 LED flashes red 3 times : Operation Error
- 3-4 LED flashes red 5 times : Code Input Error (the operation will stop for system protection.) (Refer to 17).
- 3-5 LED flashes orange 3 times: System has been restored to default setting.
- 3-6 LED flashes orange slowly while in programming mode.

4. Audio Indicator

- 4-1 1 beep sound indicates a successful operation.
- 4-2 2 long beeps indicate a successful programming
- 4-3 3 beeps indicate an operation error.
- 4-4 3 long beeps indicate that system has been restored to default setting.
- 4-5 5 beeps : Codes Input Error (the operation will stop for system protection.) (Refer to 17)
- 4-6 10 rapid beeps indicates low battery power. Batteries should be replaced immediately.

5. Programming Code

- 5-1 The preset Programming Code is 0000. Please delete and create your personal code when operating for the first time.
- 5-2 Only one Programming Code can be used for function setting.
- 5-3 Programming Code is only for function setting, you can not unlock the door by pressing Programming Code.
- 5-4 Programming code is 4-10 digits in length.
- 5-5 Programming code can be changed at anytime if needed.

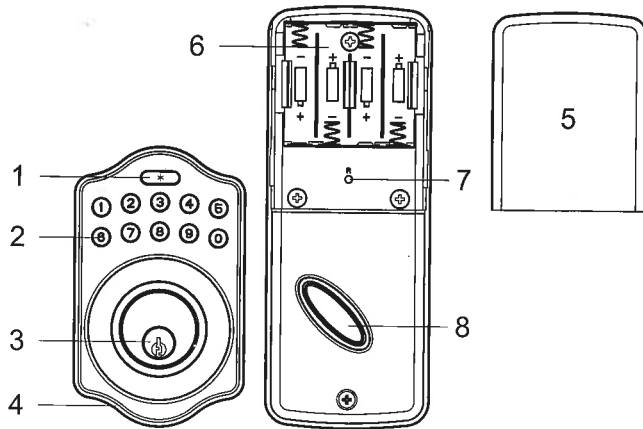

1 Programming Button

Programming Button is used for entering codes, clearing errors, setting functions and the lock button.

2 Number Buttons

Input the pass codes, each pass code can be 4-10 digits in length.

3 Cylinder

Retract / Extend the latch bolt by key from the exterior.

4 Gasket

Prevent water from permeating into lockset.

5 Battery Cover

Slide the cover to change the batteries or restore default setting.

6 Battery

Four AA (1.5V) Alkaline batteries are required.

7 R Button (Reset)

Restore default settings.

8 Thumb turn

Retract/Extend the latch bolt from the interior.

6. User Code

- 6-1 The preset User Code is 1234. Delete and create your own personal code for first time operation.
- 6-2 Up to 6 sets of User codes can be saved.
- 6-3 User Code is only for activating the lock (latch retracting).
- 6-4 User Code is 4-10 digits in length.
- 6-5 User Code can be deleted or changed anytime if needed.

7. Deleting Individual User Code

- 7-1 User Codes can be deleted individually. You can reset the same number as a user code even if deleted once before.
- 7-2 You must enter the Programming code to delete individual User codes.

8. Deleting User Codes

- 8-1 All the User Codes can be deleted at one time. You can reset the same numbers as a user code even if deleted once before.
- 8-2 Auto-locking and Keypad locking function will be invalid after deleting all User Codes and the lock can only be operated by key. All electrical functions will be restored when new User Codes have been created or entered.
- 8-3 Programming Code is required to delete all User Codes.

9. Temporarily Disabling All User Codes

- 9-1 Auto-locking and Keypad locking function will be invalid when User Codes are temporarily disabled. The lock can only be operated by key during the time.
- 9-2 Repeat the programming steps again to restore the User Codes.

10. Create a Disposable User Code

- 10-1 Disposable User Code will no longer be valid once used.
- 10-2 You can reset same number as Disposal User Code.
- 10-3 Programming Code is required to create a new Disposable User Code.

11. Resetting Factory Code

- 11-1 Reset to the Preset Factory Code by pressing "R" button on the interior of the receiver module if the Programming Code is lost or when cancelling all previous settings.
- 11-2 After resetting, the Programming Code should be 0000; User Code would be 1234.

12. Unlocking the door

- 12-1 The door can be unlocked by key or by pressing the User Code on keypad from the exterior, or by turning the thumbturn from the interior.
- 12-2 To unlock the door on the keypad, enter the User Code and then press the Programming/Enter button. **[*]**

13. Locking the door

The door can be locked by key or by pressing Programming / Enter Button **[*]** on the keypad from outside or by interior thumbturn.

14. Incomplete Door Closing / Opening

- 14-1 If the latch bolt is not extended/retracted completely. The LED will flash red 3 times and hear 3 beeps (No alarm when in mute). You need to enter User Code to unlock the door and retract the bolt, and press Programming Button to lock the door again.
- 14-2 If the latch bolt is stuck or cannot extend/retract completely at any time, check if the strike aligns with the latch bolt and adjust strike accordingly.

15. To Activate / Deactivate Auto-Locking Function

- 15-1 The door will automatically lock itself between 10-99 seconds when this function is activated.
- 15-2 This function is set to deactivate by default.
- 15-3 The preset delay-time is 30 seconds, it is adjustable
- 15-4 Repeat the same programming steps to cancel the Auto-Locking function.
- 15-5 The system will beep twice if the latch bolt gets stuck or does not extend/retract completely. You will need to enter User Code to unlock the door. The auto-locking function will then be restored.

16. Toggle Mute On/Off

- 16-1 Beeping sounds will be heard when pressing keypad, programming or operating errors. If necessary, it can be disabled.
- 16-2 LED Illumination will still be functional when in mute. Muting the "Beep" is not recommended as the alarm would be disabled.
- 16-3 Operating motor sound cannot be muted.

17.Code Protection Function

The operation will stop if entering unauthorized codes more than 5 times.
The System will operate again only after 45 sec.

18.Illumination

The LED Keypad will illuminate when pressing any button.

■ Pass Code & Function Set up

1. During programming, unit should remain unlocked.
2. Verify door handing (Refer to programming table) before function set up during first time installation or restoring default settings.
3. Please change default Programming Code (0000) and User Code (1234) before function set up during first time operation.
4. LED flashes orange slowly while programming. LED flashes green twice with 2 long beeps when code is entered correctly. LED flashes red 3 times with 3 beeps if code is entered incorrectly. (You need to wait for 6 seconds or press programming button when entered incorrectly, then re-program the system again.)
5. Every programming step should be done in 6 seconds.
6. You can lock/unlock this product by either key or pass code. Please refer to the following programming table for function set up.

■ Warnings

1. Manufacturer recommendation to use alkaline batteries.
2. Do not mix alkaline batteries with regular zinc-carbon or mixed brand batteries.
3. Do not use any chemical liquid or lubricating oil with additives to clean the lock body, this will damage the surface and possibly the lock.

■ Function Programming

Programming Code (PC)
USER Code (UC)

Detect Handing of Door



Remark: refer to pages 7 and 8 in this manual.

Add New User Code



Remark :

Up to 6 sets of User Code can be saved. User Code should be 4-10 digits in length.

Delete An Existing User Code



Delete All User Code At once



Remark : Auto-locking and Keypad locking functions will be invalid when User Codes are deleted. The lock can only be operated by key during this time.

Change Programming Code



Toggle Autolock On/Off



Remark : The preset delay-time is 30 seconds, you can change the time by following the instructions.
Repeat the steps to cancel the Auto-locking function.

Programming Code (PC)
USER Code (UC)

Set Autolock Time Delay



Remark : 10-99 seconds delay-time available.

Toggle Mute On/Off



Remark : Repeat same steps to turn beeper On/Off.
LED illumination is still functioning when in mute.
note: there will be no audible warning.

Enable/Disable All User Code



Remark : Auto-locking and Keypad locking function will be invalid when User Codes are disabled. The lock can only be operated by key during this time.
Repeat steps to enable the User Codes again.

Create a disposable User Code

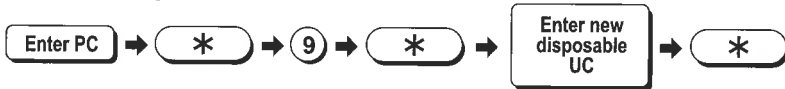

Remark : Disposable code will no longer be valid once used.

Restore all preset lock settings

Press **R**

Remark : Press "R" button for over 5 seconds, Preset settings in effect after you hear 3 long beeps.
After successful restore of preset settings, you need to run the detect handing of the door function before other function settings.

Troubleshooting

Problem 1

After installation the door cannot be locked and three short beeps are emitted when you press the Programming button.

Cause: The door-handing indentifying process is not yet complete.

Solution: Please execute the door-handing indentifying process as soon as the installation of the lockset is completed.

Problem 2

After installation, no response when you press any button (no audible sounds and the back light does not work).

Cause: It could be a problem caused by the batteries or the improper connection of the cable.

Solution: Check to see if the battery polarities have been reversed or if the batteries are dead. If so, re-install or change the batteries. If not, check if the cable is properly connected.

Problem 3

Fail in door-handing indentifying process

(the red light flashes three times, and three short beeps are emitted).

Cause: Wrong door-handing or change of the door-handing in the memory.

Solution: Press the R button to restore the system to factory default setting and re-execute door-handing indentifying function.

Problem 4

Door-handing process has been completed successfully but the latch does not work. (Motor runs powerlessly, the latch bolt is stuck, and the thumb turn inside cannot be rotated.)

Cause: Low battery.

Solution: Replace with new set of 4 AA (1.5V) Alkaline batteries.

Problem 5

Latch bolt locks up, and the thumb turn inside cannot be rotated, neither with the key or keypad.

Cause: The detection of latch bolt position is abnormal.

Solution: Remove batteries first, press any button on the front panel for electric discharge, and then re-insert batteries. The latch bolt will automatically re-detect its position subsequently.

Attention: When the latch gets stuck frequently, confirm that the opening of the strike is lined up at the central position of the latch bolt. If the latch bolt can extend freely, then inspect if the hinges are deformed or tilted.

Problem 6

The door can be locked normally, but three short beeps are heard and the door does not unlock when the user code is entered and the programming button is pressed.

Cause: The functioning of the micro-switch is abnormal.

Solution: Unlock the door with the key. Re-program the unit. If the problem persists, the unit must be replaced.

Problem 7

While the door is closed, you hear the latch bolt extending when you press the programming button to lock the door; however, three short beeps are emitted. Conversely, while the door is open, no beeps are emitted when locking the latch bolt.

Cause : (1) The depth of the latch bolt hole is insufficient.

(2) The latch bolt is not aimed at the opening of the strike.

Solution : (1) Increase the depth of the latch bolt cavity for the strike (min. depth of 2.5 cm).

(2) Adjust the strike to the appropriate position.

