

VIRO MORTISE LOCKS

SECURITY HARDWARE

VIRO DEADLATCH LOCK

8516, 8517, 8518, 8519

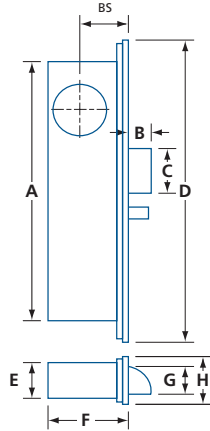

- Heavy galvanized steel construction
- Solid zinc alloy latch bolt
- Zinc alloy dead locking pin with ball bearing tip
- $1\frac{7}{32}$ " (13.6 mm) latch throw
- Reversible
- Cylinder backset: $\frac{7}{8}$ " (22.2 mm), $\frac{31}{32}$ " (24.6 mm), $1\frac{1}{8}$ " (28.6 mm) or $1\frac{1}{2}$ " (38.1 mm)
- Lock accepts standard $1\frac{5}{32}$ " (29.4 mm) diameter mortise cylinder with cam A (Adams Rite type)
- Key or turn-button controlled latch dogging
- Faceplate #9902C28 sold separately

Wide variety of padlocks and specialty locks available – please contact to order or visit www.viro.it for details

MODEL	BS	A	B	C	D	E	F	G	H
8516	$\frac{7}{8}$ (22.2)	$5\frac{13}{16}$ (147.3)	$\frac{17}{32}$ (13.6)	1 (25.3)	$6\frac{7}{8}$ (174.9)	$\frac{7}{8}$ (22.4)	$1\frac{1}{2}$ (38.2)	$\frac{5}{8}$ (16.0)	1 (25.2)
8517	$\frac{31}{32}$ (24.6)	$5\frac{13}{16}$ (147.3)	$\frac{17}{32}$ (13.6)	1 (25.3)	$6\frac{7}{8}$ (174.9)	$\frac{7}{8}$ (22.4)	$1\frac{19}{32}$ (40.6)	$\frac{5}{8}$ (16.0)	1 (25.2)
8518	$1\frac{1}{8}$ (28.6)	$5\frac{13}{16}$ (147.3)	$\frac{17}{32}$ (13.6)	1 (25.3)	$6\frac{7}{8}$ (174.9)	$\frac{7}{8}$ (22.4)	$1\frac{3}{4}$ (44.6)	$\frac{5}{8}$ (16.0)	1 (25.2)
8519	$1\frac{1}{2}$ (38.1)	$5\frac{13}{16}$ (147.3)	$\frac{17}{32}$ (13.6)	1 (25.3)	$6\frac{7}{8}$ (174.9)	$\frac{7}{8}$ (22.4)	$2\frac{1}{8}$ (54.1)	$\frac{5}{8}$ (16.0)	1 (25.2)

IN (MM)

VIRO DEADBOLT LOCK

8506, 8507, 8508

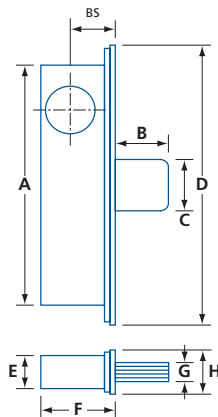

- Heavy galvanized steel construction
- Tough laminated swinging deadbolt
- $1\frac{3}{8}$ " (34.9 mm) latch throw
- Non-handed
- Cylinder backset: $\frac{7}{8}$ " (22.2 mm), $\frac{31}{32}$ " (24.6 mm), or $1\frac{1}{8}$ " (28.6 mm)
- Lock accepts standard $1\frac{5}{32}$ " (29.4 mm) diameter mortise cylinder with cam A (Adams Rite type)
- Faceplate #9934C28 sold separately

Wide variety of padlocks and specialty locks available – please contact to order or visit www.viro.it for details

MODEL	BS	A	B	C	D	E	F	G	H
8506	$\frac{7}{8}$ (22.2)	6 (152.5)	$1\frac{3}{8}$ (34.9)	$1\frac{3}{8}$ (34.3)	$6\frac{7}{8}$ (174.9)	1 (25.2)	$1\frac{17}{32}$ (38.9)	$\frac{19}{32}$ (15.0)	1 (25.2)
8507	$\frac{31}{32}$ (24.6)	6 (152.5)	$1\frac{3}{8}$ (34.9)	$1\frac{3}{8}$ (34.3)	$6\frac{7}{8}$ (174.9)	1 (25.2)	$1\frac{5}{8}$ (41.3)	$\frac{19}{32}$ (15.0)	1 (25.2)
8508	$1\frac{1}{8}$ (28.6)	6 (152.5)	$1\frac{3}{8}$ (34.9)	$1\frac{3}{8}$ (34.3)	$6\frac{7}{8}$ (174.9)	1 (25.2)	$1\frac{23}{32}$ (45.3)	$\frac{19}{32}$ (15.0)	1 (25.2)

IN (MM)