

DOREX MORTISE LOCKS

SECURITY HARDWARE

DOREX DB2100 DEADBOLT LOCK

DB21

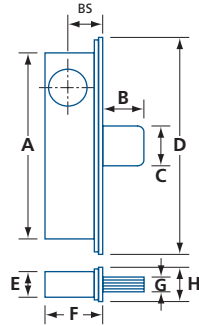

- Heavy zinc plated steel construction
- 5-ply laminated steel pivot bolt with 3 case-hardened center plies plus hardened roll pin (sawing test meets ANSI performance specifications)
- 1³/₈" (35.1 mm) bolt throw
- Non-handed
- Cylinder backset: 7⁷/₈" (22.2 mm), 3¹/₂" (24.6 mm) or 1¹/₈" (28.6 mm)
- Lock accepts standard 1⁵/₃₂" (29.4 mm) diameter mortise cylinder with cam A (Adams Rite type)
- Flat anodized aluminum (#FP11) faceplate included
- Strike not included
- Other faceplates, strikes, and accessories available, see page 05.203

MODEL	FINISH	BS	A	B	C	D	E	F	G	H	/CASE
DB2101-1	AL, DU	7 ⁷ / ₈ (22.2)	6 (152.7)	1 ³ / ₈ (35.1)	1 ³ / ₈ (34.4)	6 ⁷ / ₈ (174.6)	2 ⁹ / ₃₂ (22.8)	1 ¹⁹ / ₃₂ (40.0)	5 ⁵ / ₈ (15.3)	1 (25.4)	25
DB2102-1	AL, DU	3 ¹ / ₂ (24.6)	6 (152.7)	1 ³ / ₈ (35.1)	1 ³ / ₈ (34.4)	6 ⁷ / ₈ (174.6)	2 ⁹ / ₃₂ (22.8)	1 5/8 (41.2)	5 ⁵ / ₈ (15.3)	1 (25.4)	25
DB2103-1	AL, DU	1 ¹ / ₈ (28.6)	6 (152.7)	1 ³ / ₈ (35.1)	1 ³ / ₈ (34.4)	6 ⁷ / ₈ (174.6)	2 ⁹ / ₃₂ (22.8)	1 25/32 (45.1)	5 ⁵ / ₈ (15.3)	1 (25.4)	25

IN (MM)

DOREX DB2200 DEADBOLT LOCK – SHORT THROW

DB22

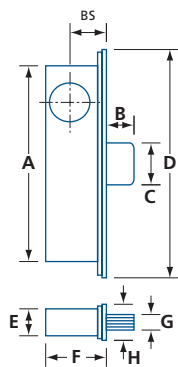

- Heavy zinc plated steel construction
- 5-ply laminated steel pivot bolt with 3 case-hardened center plies plus hardened roll pin (sawing test meets ANSI performance specifications)
- 1³/₁₆" (20.5 mm) bolt throw
- Non-handed
- Cylinder backset: 3¹/₂" (24.6 mm) or 1¹/₈" (28.6 mm)
- Lock accepts standard 1⁵/₃₂" (29.4 mm) diameter mortise cylinder with cam A (Adams Rite type)
- Flat anodized aluminum (#FP21) faceplate included
- Strike not included
- Other faceplates, strikes, and accessories available, see page 05.203

MODEL	FINISH	BS	A	B	C	D	E	F	G	H	/CASE
DB2202-1	AL, DU	3 ¹ / ₂ (24.6)	6 (152.7)	1 ³ / ₁₆ (20.5)	1 ¹¹ / ₃₂ (34.1)	6 ⁷ / ₈ (174.6)	2 ⁹ / ₃₂ (22.9)	1 ⁵ / ₈ (41.4)	5 ⁵ / ₈ (15.3)	1 (25.4)	25
DB2203-1	AL, DU	1 ¹ / ₈ (28.6)	6 (152.7)	1 ³ / ₁₆ (20.5)	1 ¹¹ / ₃₂ (34.1)	6 ⁷ / ₈ (174.6)	2 ⁹ / ₃₂ (22.9)	1 ²⁵ / ₃₂ (45.1)	5 ⁵ / ₈ (15.3)	1 (25.4)	25

IN (MM)

